

**ACCESSORIES.**

(NOT PART OF STANDARD ASSEMBLY)

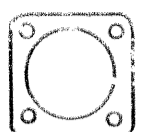

FLANGE GASKET,  
PLAIN  
10-40450-( )

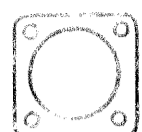

FLANGE GASKET,  
SHIELDING  
10-40450-( )S

70094-288

REVISIONS

ZONE	LTR	DESCRIPTION	DATE	APPROVED
	A			
	B	(CLTD) SEE CHANGE NOTICE ECW: 28711	6-23-94 [INITIALED]	JCB

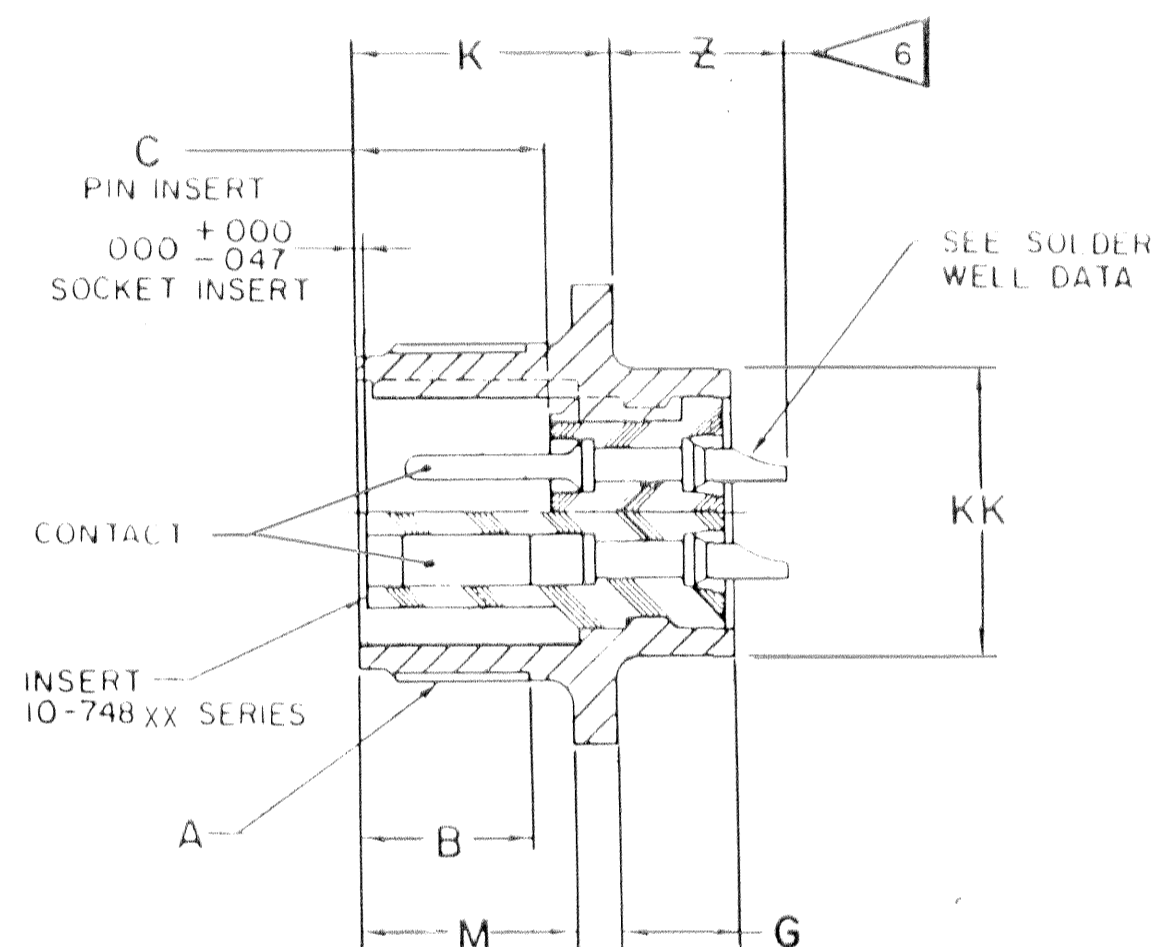
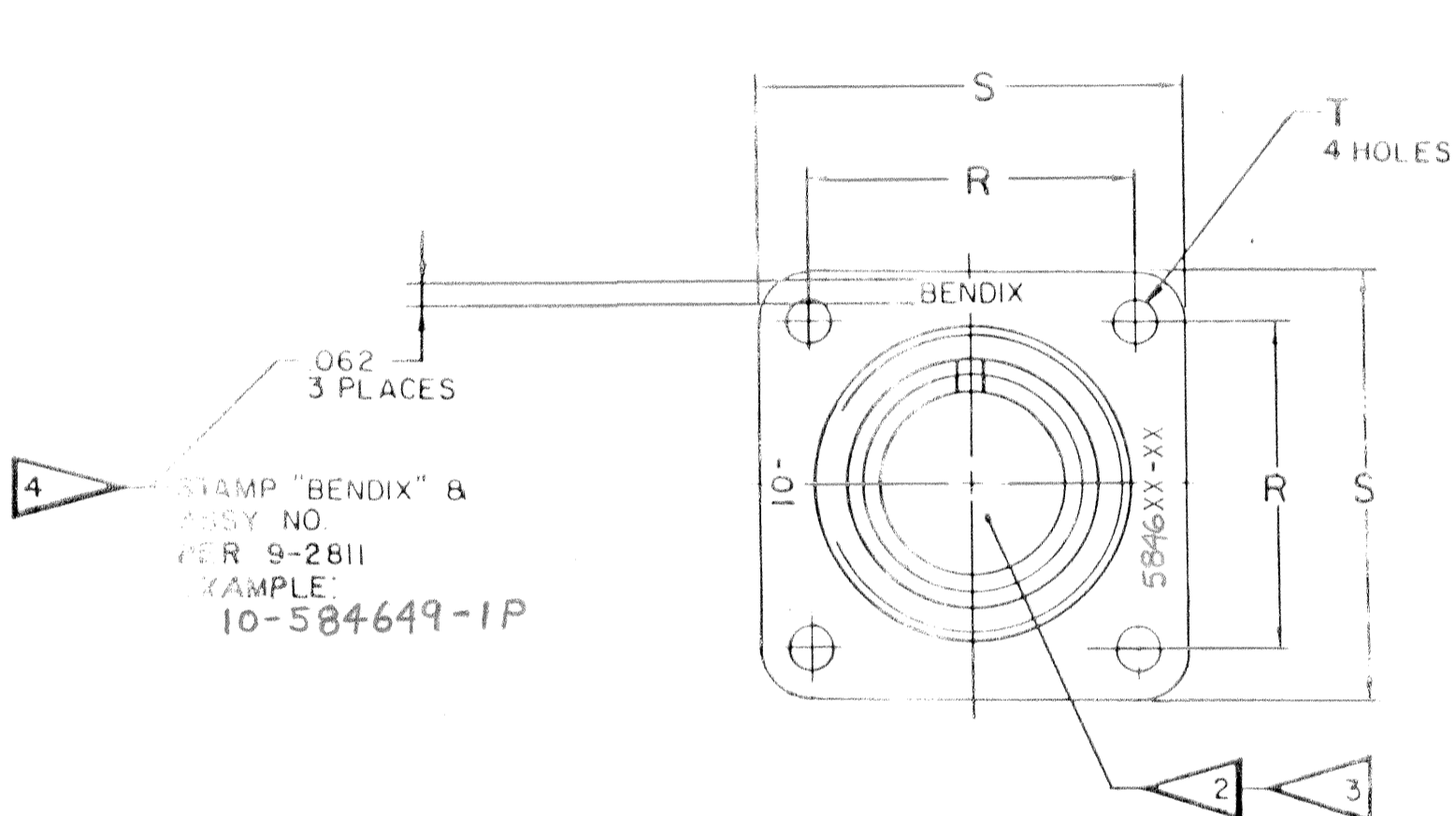

SEE SHEET 2

NOTES:

FIND NO.	QTY REQD	CODE IDENT	PART NUMBER	DESCRIPTION	NOTE REF
PARTS LIST					
UNLESS OTHERWISE SPECIFIED LINEAR DIMENSIONS ARE IN INCHES. TOLERANCES: .XXX ± .010, .XX ± .03, .X ± .1, ANGLES ± 2°. OTHER STANDARDS PER 9-3800 AND MIL-D-1000. NOTE REF			SIGNATURES PREPARED <i>D. ALGER</i> CHECKED <i>J. DeMatteis</i> MATERIAL	DATES 5-31-94 6-10-94	The Bendix Corporation Electrical Components Division Sidney, New York
MATERIAL SPEC	PROCESS SPEC TEST 9-3106-1 ASSY 9-3238-1 9-2437 9-2811	APPROVED <i>Al Davis</i>	6-16-94	TITLE: CONNECTOR, ELECTRICAL RECEPTACLE, TYPE SM-RC)FB BLACK ZINC ALLOY PLATE	
		SIZE	CODE IDENT NO.	10-584640 THRU 10-584659	
		SCALE	WT	REF	SHEET
		NONE		10-523180/99	1 OF 2

USE OF THIS DOCUMENT IS UNLIMITED. DOCUMENTS REFERENCED HEREON CONTAIN LIMITED RIGHTS DATA

NEXT ASSEMBLY

00000001

TAB.

10-584640/659

ASSEMBLY NUMBER	MS NO. REF	SHELL	A THREAD (PLATED) CLASS 2A	B MIN FULL THD	C ±.031	K +.020 -.010	M +.010 -.000	R ±.005	S	T DIA +.004 -.002	Z MAX	G +.000 -.010	KK DIA +.010 -.000
10-584640-	3102R-8S-	10-37262-8Y	.500 -28 UNEF	.391	.484	.672	.562	.594	875	120	.472	.297	.375
10-584641-	-10S-	-10Y	.625 -24 UNEF	.391				.719	1,000				.500
10-584642-	-10SL-	-11Y	.625 -24 UNEF	.391				.719	1,000				.625
10-584643-	-12S-	-12Y	.750 -20 UNEF	.450				.812	1,094				
10-584644-	-12-	-13Y	.750 -20 UNEF	.625	.672	.860	.750	.812	1,094		.722	.484	
10-584645-	-14S-	-14Y	.875 -20 UNEF	.450	.484	.672	.562	.906	1,188		.472	.297	.750
10-584646-	-14-	-15Y	.875 -20 UNEF	.625	.672	.860	.750	.906	1,188		.722	.484	.750
10-584647-	-16S-	-16Y	1.000 -20 UNEF	.450	.484	.672	.562	.969	1,281		.472	.297	.875
10-584648-	-16-	-17Y	1.000 -20 UNEF	.625	.672	.860	.750	.969	1,281		.722	.484	.875
10-584649-	-18-	-18Y	1.125 -18 UNEF			.891		1.062	1,375		.591	.453	1.000
10-584650-	-20-	-20Y	1.250 -18 UNEF					1.156	1,500				1.125
10-584651-	-22-	-22Y	1.375 -18 UNEF					1.250	1,625				1.250
10-584652-	-24-	-24Y	1.500 -18 UNEF			.953	.812	1.375	1,750	.147	.628		1.375
10-584653-	-28-	-28Y	1.750 -18 UNS			.953	.812	1.562	2,000	.147	.628		1,625
10-584654-	-32-	-32Y	2.000 -18 UNS			1.031	.875	1.750	2,250	.173	.550	.438	1,875
10-584655-	-36-	-36Y	2.250 -16 UN			1.031	.875	1.938	2,500	.173		.438	2,062
10-584656-	-40-	-40Y	2.500 -16 UN			1.031	.875	2.188	2,750	.173		.438	2,312
10-584657/59			NOT AVAILABLE										

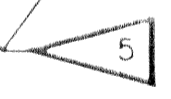

7. UNITS ILLUSTRATED MEET THE APPLICABLE REQUIREMENTS OF MIL C-5015.
6. INCREASE Z DIMENSION BY .312 FOR SIZE "O" CONTACT ONLY.
5. TO COMPLETE ASSEMBLY NUMBER & MS NO., REF, ADD APPLICABLE INSERT ARRANGEMENT SUFFIX TO BASE NUMBERS LISTED ABOVE.
4. SEE WORK ORDER FOR PERMISSIBLE ADDITIONAL OR ALTERNATE STAMPING.
3. INSERTS & CONTACTS ARE NOT REMOVABLE.
2. FOR CONTACT SIZE, SPACING & SERVICE RATING, SEE MIL-STD 1651.
1. FOR COMPONENT PART NUMBERS, QUANTITIES AND RELEASE STATUS OF DESIRED UNIT, SEE SEPARATE PARTS LIST.

NOTES:

CONTACT SIZE	0	4	8	12	16
WELL DIA	.469 +.005 -.003	.332 +.005 -.003	.209 +.004 -.002	.116 +.004 -.002	.078 +.004 -.002
WELL DEPTH	.625	.625	.500	.375	.250

SIZE C CODE IDENT NO. 77820 10-584640 THRU 10-584659

REV SYM A B SCALE WT REF SHEET 2

D  
C  
B  
A  
10-584640/659  
TAB.